



FLT SERIES

Electromagnetic level and temperature switch

The FLT is a series of electromagnetic level switches with a thermometer. The FLT range, directly fitted in the tank, monitors the level and temperature of the fluid. Several sizes and configurations are available to meet every tank requirement.



PRESSURE:	Max operating: up to 5 bar
MAX WORKING TEMPERATURE :	- 10° C + 90° C
MAX FLUID VISCOSITY	150 cSt
CONNECTIONS:	Three holes flange - 120° M4 Two holes flange - 180° M4 G1"
MATERIALS:	Rod: Stainless Steel Floating part: PA66 Housing: Anodized Aluminum Gasket: NBR
FLUID COMPATIBILITY:	Full with HH-HL-HM-HV-HETG-HEES (acc. to ISO 6743/4). For use with other fluid please contact Filtrtec Customer Service (info@filtrtec.it).

OVERALL DIMENSIONS

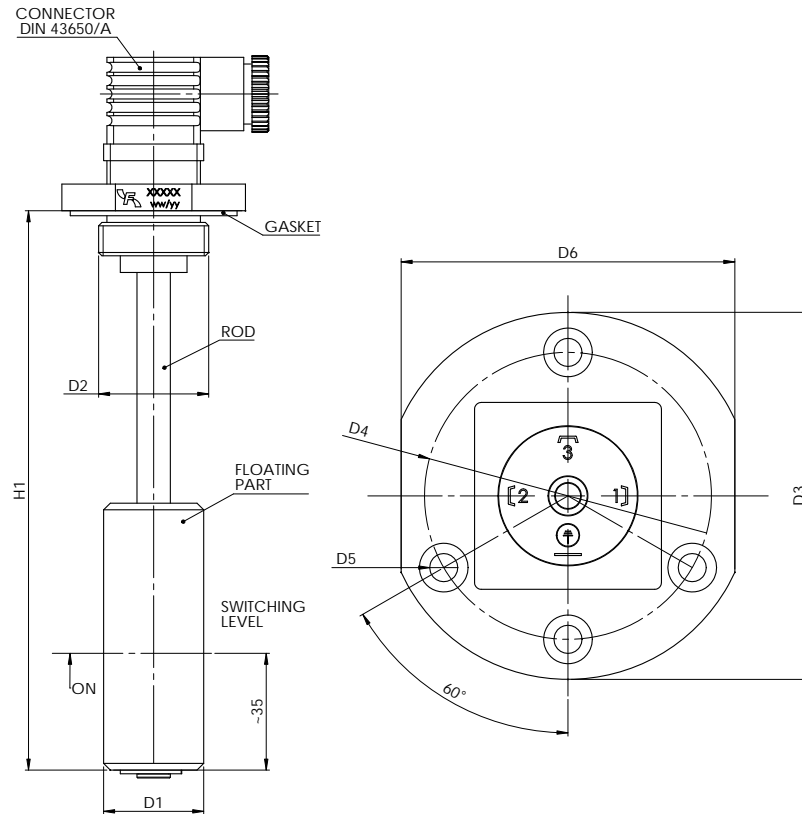

TANK MOUNTING PATTERN
THREADED VERSION G1"

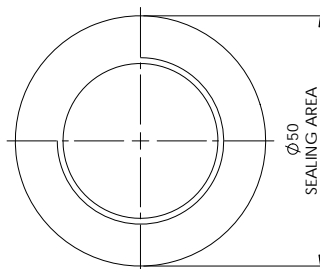

TANK MOUNTING PATTERN
FLANGED VERSION WITH 2 OR 3 SCREW M4

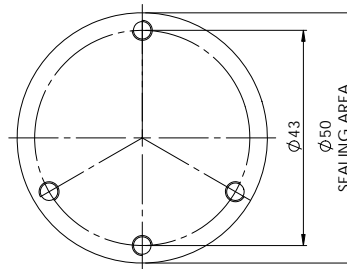

NOMINAL SIZE

CODE	H1	D1	D2	D3	D4	D5	D6	WEIGHT gr.
FLT150	150	30	G 1"	55	43	4,2	50	160
FLT200	200							175
FLT250	250							190
FLT350	350							220
FLT400	400							235
FLT500	500	265						

ORDERING INFORMATION

1.	2.	3.	4.	5.
FLT	250	A	50	A

1. SERIES	FLT	
2. SIZE	150	Rod length 150 mm
	200	Rod length 200 mm
	250	Rod length 2500 mm
	350	Rod length 350 mm
	400	Rod length 400 mm
	500	Rod length 500 mm
3. LEVEL SWITCH	A	N.O. - Normally open
	B	N.C. - Normally closed
4. SWITCHING TEMPERATURE (C°)	50	with thermometer 50°C
	60	with thermometer 60°C
	70	with thermometer 70°C
5. THERMOMETER CONFIGURATION	A	N.O. - Normally open
	B	N.C. - Normally closed

ELECTRICAL SPECIFICATIONS

- Electrical connection in accordance with DIN 43650/A
- Electrical protection in accordance with DIN 40050-IP65
- Maximum electrical load N.O./N.C. 30V AC/DC - 0,25A
- Other electrical features on request

CONNECTION PG9
CABLE Ø 6-8 (A) + (B) + (C) + (D)

CONNECTION PG11
CABLE Ø 8-10 (A) + (B) + (C)

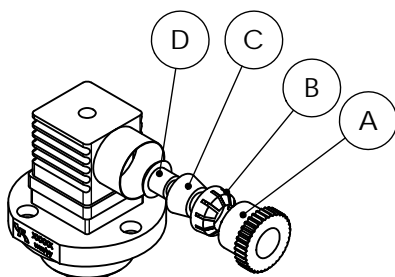

ELECTRICAL DIAGRAM

N.O. / N.O.

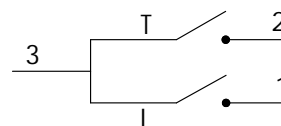

N.C. / N.O.

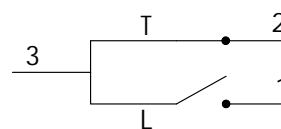

N.O. / N.C.

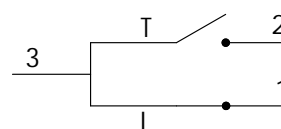

N.C. / N.C.

