

1.6 Anti-cavitation valves C/...

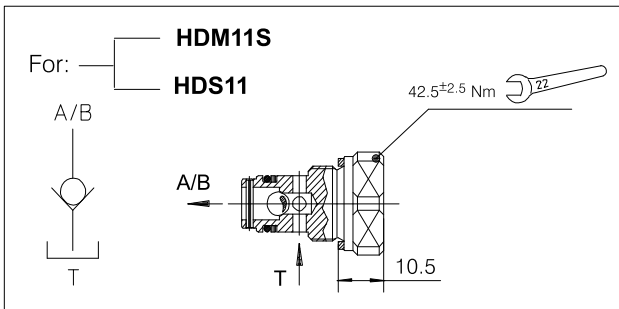

Type	Code
C/A or C/B	200.7876.0093.0
VC (plugged valve)	200.7784.0004.0

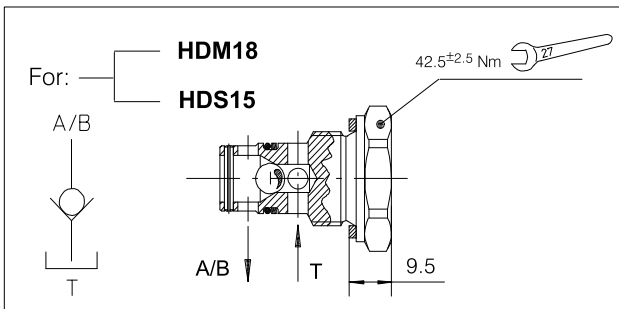

Type	Code
C/A or C/B	200.7876.0143.0
VC (plugged valve)	200.7784.0005.0

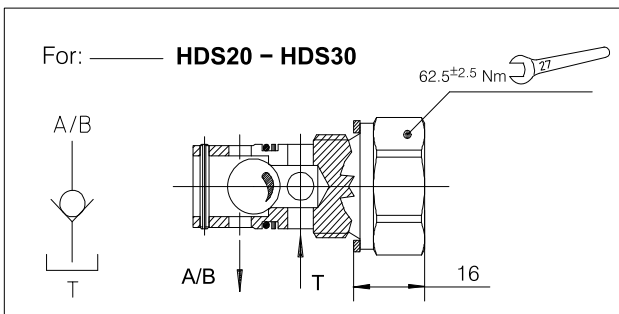

Type	Code
C/A or C/B	200.7876.0144.0
VC (plugged valve)	200.7784.0007.0

1.7 Anti-shock valves OA/...

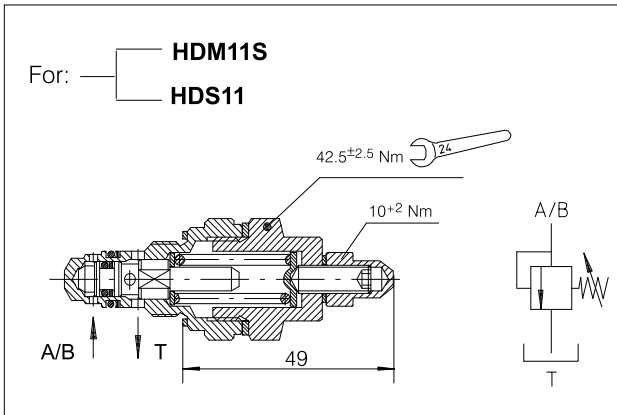

Pressure set range bar (PSI)	Type	Code	Spring code
0 - 30 (0-400)	OA/A02 OA/B02	200.7874.0092.0	200.6624.0113.0
31 - 130 (400-1900)	OA/A06 OA/B06	200.7874.0094.0	200.6624.0070.0
131 - 300 (1900-4300)	OA/A15* OA/B15	200.7874.0093.0	200.6624.0077.0
VC (plugged valve)		200.7784.0004.0	-

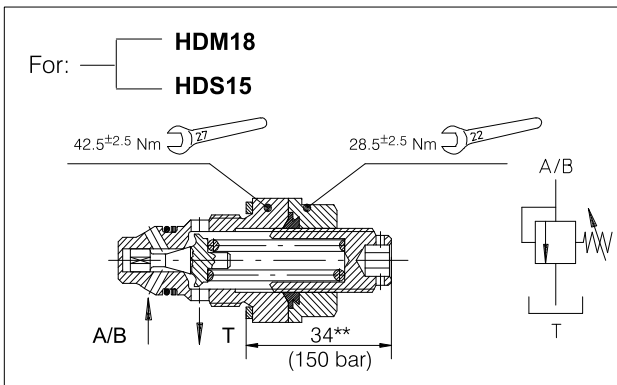

Pressure set range bar (PSI)	Type	Code	Spring code
0 - 130 (0-1900)	OA/A06 OA/B06	200.7874.0095.0	200.6624.0115.0
131 - 350 (1900-5000)	OA/A15 OA/B15	200.7874.0096.0	200.6624.0116.0
VC (plugged valve)		200.7784.0005.0	-

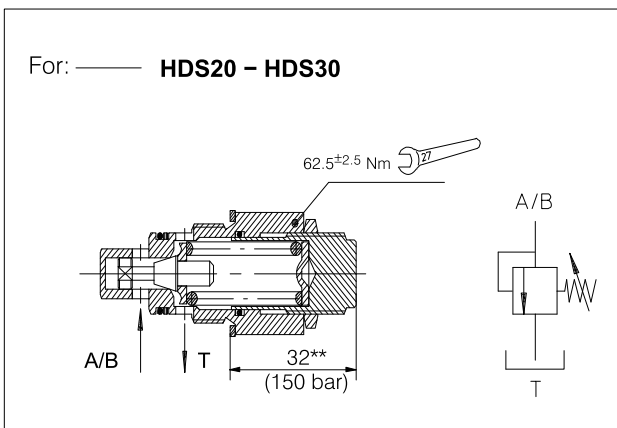

Pressure set range bar (PSI)	Type	Code	Spring code
0 - 95 (0-1300)	OA/A06 OA/B06	200.7874.0108.0	200.6624.0145.0
96 - 210 (1300-3000)	OA/A15 OA/B15	200.7874.0113.0	200.6624.0148.0
211 - 350 (3000-5000)	OA/A26 OA/B26	200.7874.0110.0	200.6624.0146.0
VC (plugged valve)		200.7784.0007.0	-

Example : OA/A15** = 150 bar standard set value. Different set values have to be specified at the order. Please pay attention that any increasing/decreasing from 150 bar has to be fixed in step of 10 bar.

** : This length changes as function of the pressure relief valve setting

1.8 Anti-shock and anti-cavitation valves UC/...

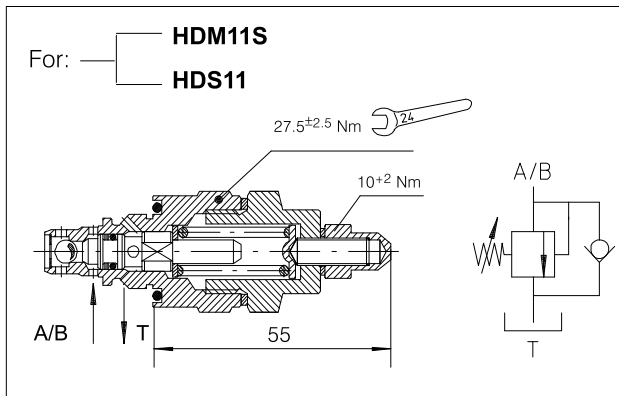

Pressure set range bar (PSI)	Type	Code	Spring code
0 - 30 (0-400)	UC/A02 UC/B02	200.7874.0126.0	200.6624.0113.0
31 - 130 (400-1900)	UC/A06* UC/B06	200.7874.0129.0	200.6624.0070.0
131 - 300 (1900-4300)	UC/A15 UC/B15	200.7874.0127.0	200.6624.0077.0
VC (plugged valve)		200.7784.0004.0	-

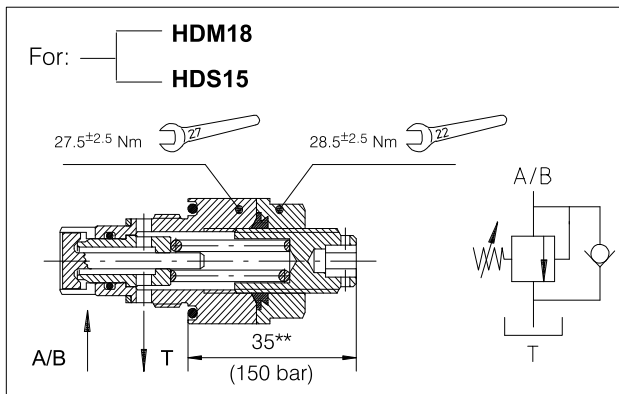

Pressure set range bar (PSI)	Type	Code	Spring code
0 - 130 (0-1900)	UC/A06 UC/B06	200.7874.0131.0	200.6624.0115.0
131 - 350 (1900-5000)	UC/A15 UC/B15	200.7874.0132.0	200.6624.0116.0
VC (plugged valve)		200.7784.0005.0	-

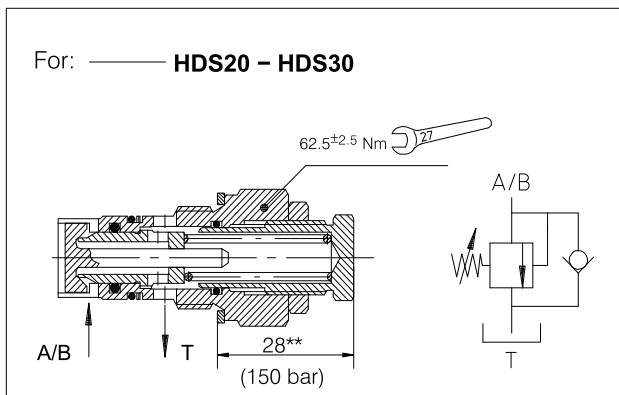

Pressure set range bar (PSI)	Type	Code	Spring code
0 - 95 (0-1300)	UC/A06 UC/B06	200.7874.0136.0	200.6624.0105.0
96 - 210 (1300-3000)	UC/A15 UC/B15	200.7874.0138.0	200.6624.0107.0
211 - 350 (3000-5000)	UC/A26 UC/B26	200.7874.0137.0	200.6624.0106.0
VC (plugged valve)		200.7784.0007.0	-

Example: UC/B06* = 60 bar standard set value. Different set values have to be specified at the order. Please pay attention that any increasing/decreasing from 60 bar has to be fixed in step of 10 bar.

** : This length changes as function of the pressure relief valve setting

1.9 Tightening torque values

Component description to be assembled	Nm
Position control sleeve screwed to spool	10 + 2
End caps handles (2 X M5 screws for HDM140-HDM11-HDS11)	8 + 2
End caps handles and position control sleeves (2 X M6 screws for HDM18-HDM25-HDS15-HDS20-HDS30)	8 + 2
"HDS07- HDS11" stack (3 X M8 bolt)	16 + 2
"HDS15" stack (3 X M8 bolt)	18 + 2
"HDS20" stack (4 X M8 bolt)	20 + 5
"HDS30" stack (4 X M10 bolt)	25 + 5